



\***CITYFUTURES**

# Annual Report 2008

**CITY FUTURES RESEARCH CENTRE**

Faculty of the Built Environment, University of New South Wales

ISSN 1838-1219

June 2009

 **AHURI** UNSW/UWS  
RESEARCH CENTRE

 **UNSW**  
THE UNIVERSITY OF NEW SOUTH WALES

## TABLE OF CONTENTS

1. INTRODUCTION AND SUMMARY.....	1
2. CENTRE STAFF, VISITORS AND ASSOCIATES, 2008.....	4
3. PERFORMANCE AGAINST TARGETS.....	7
4. CITY FUTURES WEBSITE.....	11
5. DESCRIPTION OF RESEARCH PROJECTS IN PROGRESS OR COMPLETED IN 2008.....	14
6. DISSEMINATION: PUBLICATIONS, PRESENTATIONS, SEMINARS .....	25
7. TEACHING AND SUPERVISION.....	34
8. STATEMENT OF FINANCIAL PERFORMANCE.....	39

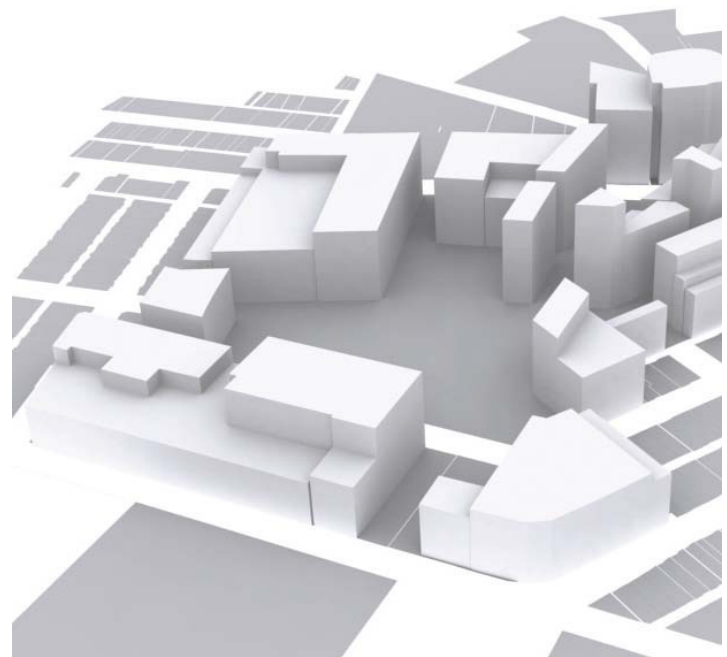

# 1

## INTRODUCTION AND SUMMARY

## 1

## INTRODUCTION AND SUMMARY



Prof Bill Randolph, Director  
City Futures Research  
Centre

The City Futures Research Centre is a University Research Centre within the Faculty of the Built Environment at the University of NSW. It was officially established in May 2006 and formally launched in early June 2006 by the Honourable Kim Carr MP, then Federal Shadow Spokesperson on Housing and Urban Affairs, now the Federal Minister for Innovation, Industry, Science and Research.

The Centre's main foci are the inter-related areas of housing, urban planning, urban design, development and policy and its research interests encompass the social, economic and environmental aspect of contemporary city dynamics. The Centre represents one of the leading concentrations of full-time and associated researchers and postgraduates in urban and housing policy issues in Australia. It incorporates the successful UNSW/UWS Australian Housing and Urban Research Institute (AHURI) Research Centre, which was established in January 2000.

One of the key strengths of City Futures is its ability to draw directly on the wider expertise and interests of Faculty staff as well as aiming to work closely with colleagues in other UNSW Faculties who wish to come together with Centre members to research aspects of urban growth and policy.

The development of the new centre was stimulated by the appointment of Prof. Bill Randolph in August 2004 and his team of full time researchers who constituted the core of the new Centre, together with A/Prof Bruce Judd at the FBE. With support from the Faculty and the University, City Futures has been effectively in operation since late 2004. By the end of 2008, research funding totalling \$5.4m had been attracted to the Centre.

### Highlights for 2008

2008 was a year of significant advancement for the Centre. A major milestone was passed during the year with the Centre's first Three Year Review. This took place in August and the Centre was assessed as having met, and indeed exceeded, its original goals and was judged in a good position to proceed. With regard to our external profile, the Review Committee noted that:

*The Centre has established an excellent network within the community and its work is well regarded by external stakeholders in both the public and private sectors.*

This network is critical to our continued success. We very much value our relationships with research Partners from outside the University sector, without whose support much of our research activity would not be possible.

The Review made several recommendations, including the appointment of a Centre Manager to support the management of the Centre, a continuing broadening of the funding base and the proposition to develop the role of the Centre as a 'host' for sustainable built environment research across UNSW. All these have subsequently been pursued and will become operational in 2009.

Several major opportunities to extend the scope of the Centre were also taken during the year. In July, we applied for and received funding under the DVC Research's Strategic Research Initiative funding stream to appoint *Ass Prof Vivienne Milligan* for a three-year term. Dr Milligan has an exemplary track record in applied housing research and policy development, having worked for many years at senior levels in several State housing authorities and, more recently, as the Director of the Sydney University AHURI Research Centre. Vivienne joined us to develop her affordable housing research interests, especially through AHURI.

In June, City Futures was a leading member of a consortium of eight Universities led by UNSW in applying for funding under the National Climate Change Adaptation Research Facility (NCCARF) to host the *Australian Climate Change Adaptation Research Network for Settlements and Infrastructure*. This is one of the eight national research networks to be funded by the NCCARF initiative. The bid was successful and in October funding amounting to \$1.788m over four years was allocated to the Network. Prof Randolph will head up the *Built Environment* node, one of four nodes under ACCARNSI, which will start in 2009.

On the grant front, 2008 was a particularly successful year. The Centre applied for 2 ARC Linkage and 2 ARC Discovery grants and was successful in obtaining funding for three of these. The allocated funds, including Partner contributions, totalled \$935,000. In addition, we were successful in receiving funding for three AHURI projects. All these projects will commence in 2009, and will substantially underwrite the activities of the Centre for the next two years. We therefore ended the year in a very strong position and we are looking forward to the next three years of the Centre with considerable confidence.

### Staffing

The year was one of modest, but significant, growth in staffing. In addition to Dr Milligan, Dr Jack Barton formally joined us in April as a Senior Research Fellow to work on the ARC funded *Urban IT* project, which combines GIS and 3D modelling of urban neighbourhoods to deliver a data rich spatial decision support system. His skills in city modelling and databases add considerable strength to our emerging capacity in this exciting area. It links closely to the further development of the Centre's cadastrally-based urban analysis capacity. During the year the value of this capacity was shown in the research undertaken for Landcom on urban fringe housing markets and underpins the two successful ARC linkage applications. We hope to build substantially on this capacity in the next few years.

Up to date news, reports and staff information can be accessed throughout the year on our website: [www.cityfutures.net.au](http://www.cityfutures.net.au).

A handwritten signature in black ink, appearing to read 'Bill Randolph'.

Prof Bill Randolph  
Director, City Futures Research Centre

May 2009

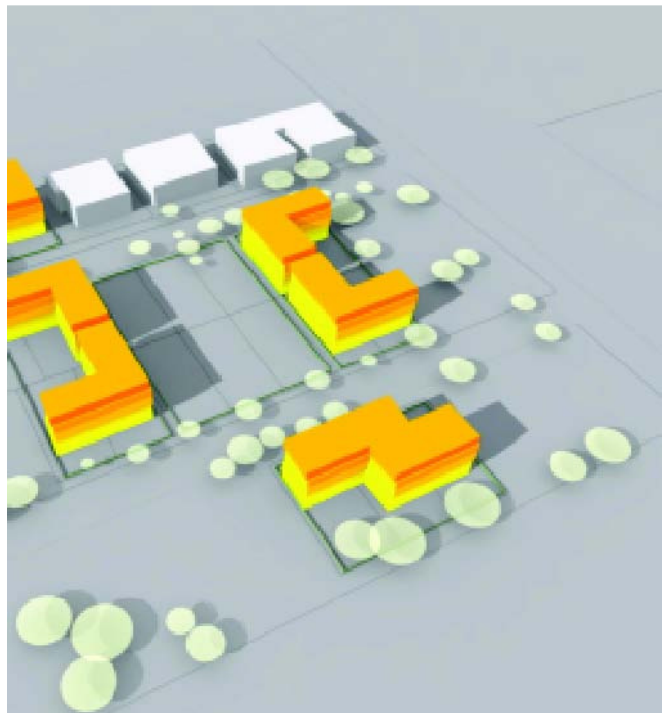

# 2

## CENTRE STAFF, VISITORS AND ASSOCIATES, 2008

# 2

## CENTRE STAFF, VISITORS AND ASSOCIATES, 2008

### CITY FUTURES MANAGEMENT BOARD

- **Prof Alec Tzannes (Chair)**, Dean, Faculty of the Built Environment (October 2008 onwards)
- **Prof Peter Murphy (Chair)**, Dean, Faculty of the Built Environment (Retired October 2008)
- **Ms Shelly Wood**, General Manager, Faculty of the Built Environment
- **Prof Martin Loosemore**, Associate Dean of Research, Faculty of the Built Environment
- **Prof Robert Freestone**, Acting Associate Dean of Research, Faculty of the Built Environment
- **Prof Bill Randolph**, Director City Futures Research Centre
- **Dr Simon Pinnegar**, Deputy Director, City Futures Research Centre
- **Dr Bruce Judd**, Visiting Senior Research Fellow
- **Prof Jane Marceau**, Visiting Professorial Fellow

Prof Peter Murphy retired from his position as Dean of Faculty of the Built Environment and stepped down as Chair of City Futures Research Centre's Management Board. His position has been replaced by Prof Alec Tzannes.

Three formal Management Board Meetings took place in 2008 on 1<sup>st</sup> May, 8<sup>th</sup> September and 11<sup>th</sup> December.

### CENTRE STAFF 2008

- **Prof Bill Randolph**, Centre Director
- **Dr Simon Pinnegar**, Deputy Director
- **A/Prof Vivienne Milligan**, A/Prof (appointed August 2008)
- **Dr John Mitchell**, Senior Research Fellow
- **Dr Kristian Ruming**, Research Fellow
- **Dr Hazel Easthope**, Research Associate
- **Joanne Quinn**, Research Associate
- **Andrew Tice**, Senior Research Officer
- **Dana Quintal**, Research Officer (resigned February 2008)
- **Jack Barton**, Research Fellow
- **Maria Schwensen**, Administrative Coordinator
- **Brooke Dinning**, Research Assistant, May - August 2008
- **Kwoh-Jack Tan**, Research Assistant, May - October 2008

## VISITING STAFF 2008

- **Dr Bruce Judd**, Visiting Senior Research Fellow
- **Dr Raymond Bunker**, Visiting Senior Research Fellow
- **Prof Jane Marceau**, Visiting Professorial Fellow
- **Prof Patrick Troy**, Visiting Professorial Fellow
- **Prof Jennifer Westacott**, Visiting Professorial Fellow
- **Dr Judy Stubbs**, Adjunct Senior Research Fellow
- **Prof Michael Eyers**, Visiting Professorial Fellow

## FBE ASSOCIATE STAFF 2008

In addition to the Centre staff, the following 7 Faculty and other UNSW staff were actively associated with the Centre during 2008.

- **Prof Peter Murphy, Dean:** Economic development, immigration policy, coastal migration, peri-urban areas, urban economics.
- **Prof Rob Freestone, Acting Associate Dean Research:** Planning history and heritage.
- **A/Prof Susan Thompson, Head of Planning Program:** Planning and development approval, cultural aspects of urban life, health and planning, social planning.
- **Jim Plume, Head of School:** Building Information Modelling, spatial decision support systems, architecture and technology.
- **Peter Williams, Senior Lecturer, Planning Program:** Planning law and legislation, development approval, governance and housing affordability.
- **Dr Oya Demirbelik**, Head of Industrial Design Program, Supervision of Joanne Quinn, AHURI Top-up Scholar and co-investigator of successful AHURI grant application on adaptable housing to start in 2007.
- **Dr Alan Morris, School of Sociology:** Dr Morris has been associated with two AHURI projects in the last three years. Dr Morris reports formally to the Head of School of Sociology.

## SIGNIFICANT MANAGERIAL OR PERSONNEL CHANGES

**Vivienne Milligan** joined City Futures Research Centre as an Associate Professor and researcher (part time) in August 2008. A geographer and housing policy expert, she completed a BA Hons at the University of Sydney in 1973 and worked in academia for a decade (1973-1982) before returning from a highly successful career in public sector administration (1983-1999) to complete a doctoral thesis at the University of Utrecht in the Netherlands in 2003. She was Director of the AHURI Sydney Research Centre at the University of Sydney between 2004 and 2008 and was appointed an Adjunct Associate Professor there in 2005.

In addition to having a core focus on housing policy, Vivienne's research and policy interests include urban renewal and community revitalisation, housing market dynamics and comparative housing research. Prior to returning to academia in the last decade, Vivienne had over 20 years of senior management experience in housing policy development and innovation in Australia, working at different times in the federal and three state jurisdictions. During her public sector career she was instrumental in developing new initiatives in public, community, Indigenous and affordable housing. She is highly regarded across Australia for her contributions to



housing policy development and was awarded a Public Service Medal for her contributions to the social housing sector in Queensland in 1993. Vivienne has also held several important positions in non-government organisations. Her past Directorships include the Australian Institute of Health and Welfare (1992-98), City West Housing (1994), the Australian Housing and Urban Research Institute (1997-99), and the Australasian Housing Institute (2001-04). From 2003 to 2005 she was the foundation editor of *HousingWORKS*, the journal of the Australasian Housing Institute.

In 2006 Vivienne helped to instigate a professional development course on affordable housing which has since been in strong demand across Australia. Vivienne also works as a private consultant and has conducted projects on a broad range of housing issues for government and non-government housing agencies, including evaluations of several housing projects and programs and provided strategic advice to most Australian state and territory government agencies and several not-for-profit sector organisations on housing-related issues. Presently she is an adviser to the Not For Profit Housing Sector Development Sub-Group of housing officials, and an expert member of the NSW Community Housing Advisory Committee and the Living Communities Consultative Committee, both convened by Housing NSW.

## RESEARCH PARTNERSHIPS

City Futures is engaged in research with a range of academic partners.

### AHURI

- A/Prof Catherine Bridge, CHAA, UNSW
- A/Prof Nicole Gurran, University of Sydney
- Prof Terry Burke and A/Prof Kath Hulse, Swinburne University, Melbourne
- Dr Tim Seelig, University of Queensland
- Prof Judy Yates, University of Sydney
- Prof Peter Williams, Centre for Housing Studies, University of York

### Other active Research Partnerships

- A/Prof Ron Cox, Faculty of Engineering, UNSW and National Climate Change Adaptation Research Facility
- Prof Brendan Gleeson, Griffith University
- Prof Steven Dovers, Fenner School, Australian National University
- Prof Ruth Fincher, Department of Geography, University of Melbourne

### Active Industry/Government Partners

- Andreones Lawyers
- City of Sydney
- City of Penrith
- City of Auburn
- City of Bankstown
- City of Fairfield
- Department of Health and Ageing
- Department of Innovation, Industry, Science and Research

- Department of Families, Housing, Community Services and Indigenous Affairs (FaHCSIA)
- Housing NSW
- Institute of Strata Title Management
- Landcom
- Lannock Strata Finance
- Macquarie Bank
- NSW Department of Fair Trading
- NSW Department of Lands
- NSW Department of Planning
- Owners Corporation Network
- SIMmersion Ltd
- Sydney Morning Herald
- Sydney Olympic Park Authority
- Urban Development Institute of Australia
- WSROC

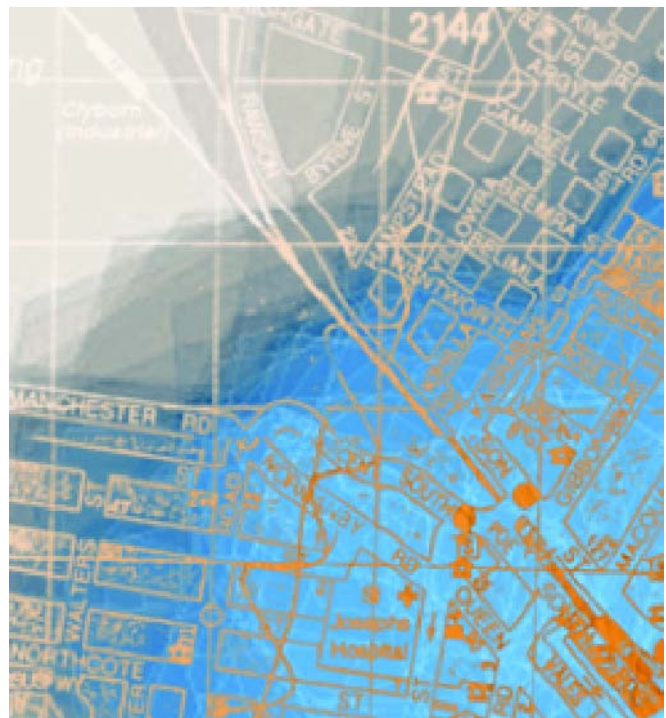

# 3

## PERFORMANCE AGAINST TARGETS

# 3

## PERFORMANCE AGAINST TARGETS

The following table sets out the Centre's performance against financial and other performance targets that were considered achievable under projected staffing and capacity.

<b>City Futures Research Centre: 2008 targets and achieved outcomes</b>		
	<b>2008 Target</b>	<b>2008 Actual</b>
<b>Financial Targets</b>		
<b>Income</b>		
Internal Funds	\$240,000	\$ 197,392*
External Funds	\$800,000	\$1,197,009
<b>Total income</b>	<b>\$1,040,000</b>	<b>\$1,394,401</b>
<b>Performance Targets</b>		
Total projects underway	n/a	14
No. of publications eligible for DEST	15	18
No. of industry partner based projects	6	6
No. of media references/mentions	30	52
No of Australasian conference presentations	12	11
No of International conference presentations	5	7
No. of community/practice presentations	12	31
Post-graduate students (actual)	7	16
Post-graduate completions (cumulative)	4	1
Associate Faculty staff	10	7

\*Received originally \$311,703.00 from DCV's office (under condition that funds had to be spent in 2008)

# 4

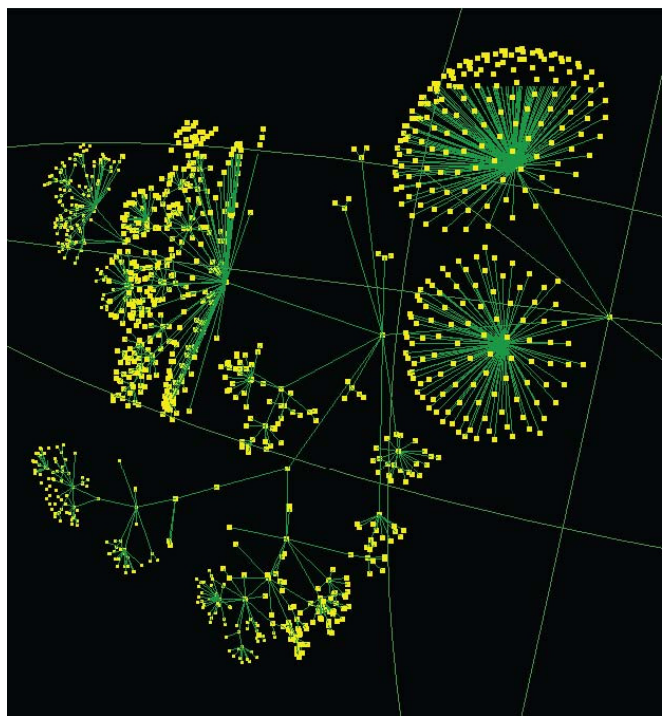

## CITY FUTURES WEBSITE

# 4

## CITY FUTURES WEBSITE

Visits and page views to City Futures Research Centre's website are monitored through *Google Analytics*. During December 2008, our website was under reconstruction and visits to the website were not recorded.

The Centre launched a re-designed and improved website at the end of the year.

**Number of visitors to [www.cityfutures.net.au](http://www.cityfutures.net.au) in 2008.**

	<b>Page views</b>	<b>Unique visitors</b>
January	1847	396
February	2283	381
March	1630	436
April	1622	402
May	1775	438
June	1939	487
July	1353	298
August	2862	530
September	1407	334
October	2862	607
November	2069	328
December	28	19
Average	1806	388

Traffic was highest in August and October, coinciding with the release of City Futures newsletters.

**7,861 visits came from 87 countries/territories:**

<b>Country</b>	<b>Visits</b>
Australia	6,659
United States	177
United Kingdom	147
New Zealand	98
China	98
Canada	51
Hong Kong	43
(not set)	39
India	36



**The most viewed project web pages were:**

ARC LP776642 - UrbanIT

(/cityfutures/research/cityfutures/projects.asp?id=informationmodel)

- 333 Page views
- 230 Unique Views

ARC DP0773388 – The Demand for Higher Density Housing in Sydney and Melbourne (/cityfutures/research/cityfutures/projects.asp?id=higherdensity)

- 192 Page views
- 152 Unique Views

AHURI Project 70902 – The Efficient Use of Dwellings and Land by Older Home Owners (/cityfutures/ahuri/projects.asp?id=olderhomeowners)

- 77 Page views
- 56 Unique Views

**Two of AHURI Project Research Reports were listed on AHURI's top 20 most downloaded report list (downloaded from <http://www.ahuri.edu.au>)**

Report	Downloads
Innovative Financing for Homeownership: The potential for shared equity in Australia. Positioning Paper	216
The Housing Affordability Impacts of Local Government Building Controls, State Government Charges Positioning Paper.	144
Other AHURI project reports produced by City Futures Staff	73

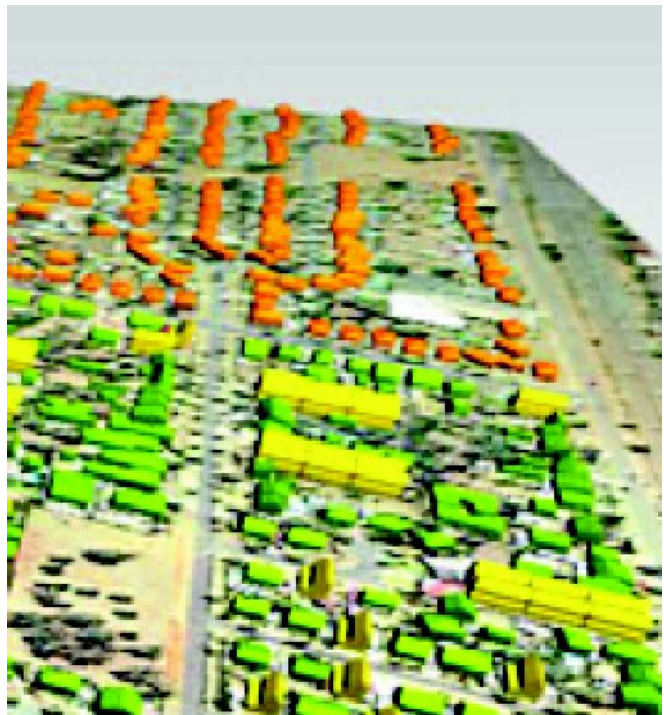

# 5

## DESCRIPTION OF RESEARCH PROJECTS IN PROGRESS OR COMPLETED IN 2008



## 5

## DESCRIPTION OF RESEARCH PROJECTS IN PROGRESS OR COMPLETED IN 2008

### LIST OF PROJECTS COMPLETED DURING 2008

Project Name	Funded by	Start	Total Funds
ARC LP0562419 - Planning for Socially Sustainable Urban Renewal	ARC	2005	\$ 179,000.00
Negotiating Development Approval in NSW: recognising formal and informal development relations	Internal UNSW Grant	2008	\$ 15,100.00
Innovation and Technology Challenges for the Built Environment Industry	DIISR	2008	\$ 24,655.00
Baseline Monitoring and Evaluation of Building Stronger Communities	Housing NSW	2008	\$ 193,528.00
Fringe, Renewal Trends: Briefing February 2008	Landcom	2008	\$ 17,675.00
30 Year Plan for Greater Adelaide	KPMG	2008	\$ 28,000.00

### LIST OF PROJECTS ONGOING AT END OF 2008

Project Name	Funded by	Start	Total Funds
ARC DP773388 - The Demand for Higher Density Housing in Sydney and Melbourne	ARC	2007	\$ 327,600.00
ARC LP0776642 - An Integrated Information Model to Support Metropolitan Planning	ARC	2006	\$627,000.00
ARC LP0668205 - Assessing the Effectiveness of Public Housing Estate Regeneration in NSW	ARC	2005	\$ 441,782.00
The Housing Affordability Impacts of Local Government Building Controls, State Government Charges and Other Regulations	AHURI	2007	\$ 116,244.00
The Efficient Use of Dwellings and Land by Older Homeowners	AHURI	2007	\$ 209,102.00
Innovative Financing for Homeownership: the potential for shared equity in Australia	AHURI	2007	\$ 160,285.00
Innovations in the Provision of Affordable Housing	AHURI	2007	\$ 18,409.00

Low-Income Home Ownership Support Programs: A Review of Past Schemes and Consideration of Future Potential	AHURI	2008	\$ 113,684.00
MOSAIC Baseline Survey	Housing NSW	2008	\$ 163,963.00
Managing Major Repairs in the Residential Strata Sector	NSW Office of Fair Trading	2008	\$ 50,000.00
Heritage Study Publication	Department of Environment, Water, Heritage and the Arts	2008	\$ 6,954.55

## ARC LINKAGE PROJECTS

### **The Demand for Higher Density Housing in Sydney and Melbourne (ARC DP773388)**

The building of residential dwellings at higher densities than the current housing stock (e.g. flats and units) is an urban growth management policy in most capital cities in Australia. Proponents of urban consolidation policies contend that there are economic, social and environmental benefits to be gained from building out cities at higher densities. There is also a body of researchers who claim that little evidence exists to support these proposed benefits. This project aimed to increase our knowledge of the impacts of urban consolidation policy by analysing some of the social, behavioural and transport assumptions that lie behind urban consolidation policy in Sydney and Melbourne and to examine whether the perceived benefits of urban consolidation are experienced by individuals who live in such dwellings.

The project was awarded in November 2006 and started in January 2007. The research was completed in December 2008. At present the research team are working on conference papers, working papers and journal articles drawing upon the results of the research.

The research consisted of a telephone survey of 1,202 apartment residents in addition to a web-survey of 420 apartment residents and in-depth interviews with 29 apartment residents. In addition, analysis was undertaken on the changes in higher-density sub-market populations between 2001 and 2006 using customised data from the 2006 Census. From this analysis key variables were identified for inclusion in a factor analysis process designed to identify key high density submarkets in order for comparisons to be made between the two cities both in terms of profile of such markets and differences in spatial distribution.

Some of the results of the research were presented at strata managers' forums in Sydney and Melbourne, hosted by Andreones Lawyers. One (peer reviewed) paper was presented at the State of Australian Cities Conference 2007. A paper based on the research findings was also presented at the Institute of Australian Geographers conference in July 2008. A press release detailing some of the findings was also published in the Sydney Morning Herald on 27<sup>th</sup> October 2007. The researchers also published a peer reviewed article in the journal *Housing Studies* [2009, 24(2):243-260].

Three working papers have already been published on the project webpage <http://www.fbe.unsw.edu.au/cf/research/cityfuturesprojects/higherdensity/>

The researchers intend to develop these papers further into peer reviewed conference papers and journal articles.

### **An Integrated Information Model to Support Metropolitan Planning (ARC LP0776642)**

The project has nearly completed its first year.

In summary, personnel in partner organisations were interviewed in conjunction with an on-line survey, supplemented by follow-up meetings where appropriate. We have held Advisory Meetings with our Partner Organisations on the following dates in order to report progress and get feedback: Kickoff Meeting 22 Nov 2007, Advisory Committee meetings on 28 Mar 2008, 26 June 2008, and 5 Dec 2008.

Based on the surveys and a study of the key planning documents, we have completed the development of a set of OWL-based Ontologies for the following urban information sets:

- The EXPRESS/IFC Schema with Enumerators and Property Sets
- CityGML, GBXML and LandXML Schemas (with data conversion tests to IFC)
- Entities mapped from ABS, BoM, NSW Cadastre, LEP and DCP glossaries
- 3D massing of South Sydney LEP 1998
- Google Earth's KML Schema and a verbose list of Australian Geographic Coordinate systems.
- Initial work has been completed on the BASIX, Strata Tiles, City of Sydney's Design Excellence DCP and Floor Space and Employment Survey.
- Also, an experimental map of SEPP10 and SEPP65 has been prepared.

We have developed these Ontologies to describe the elements of the disparate datasets in order to harmonise elements and resolve conflicts in syntax. Ontologies are a building block for the semantic web. They not only verbosely list the components in a field of interest, but how those components relate to each other, how they differ from case-to-case and how they combine to answer fuzzy queries and help provide solutions to meaningful problems. This Ontology work has lead to a cross-faculty collaboration the UNSW School of Information Systems and Management. We have also instigated a working relationship with the British Ordnance Survey, Open GeoSpatial Consortium (OGC) and CityGML initiatives with the foresight of advising development and international knowledge sharing.

The three use-case studies have now been agreed with the Partner Organisations (as outlined below) and will proceed during the second stage of the project. 3D geometry of Green Square's existing and proposed built form is complete. We are awaiting delivery of BASIX data from the Department of Planning and the Floor Space and Employment Survey Data from City of Sydney.

For more information regarding this project, please visit the project website: <http://www.fbe.unsw.edu.au/cf/research/cityfuturesprojects/urbanit/>

### **Planning for Socially Sustainable Urban Renewal in Suburban Sydney (ARC LP0562419)**

The close of 2008 saw the successful completion of this ARC Linkage project looking at the critical issue of socially sustainable renewal in aging suburban areas of Australian cities. The research was conducted in collaboration with Councils from across the region – Auburn, Bankstown, Fairfield and Penrith – together with the Western Sydney Regional Organisation of Councils (WSROC) and Housing New South Wales. Focusing on the predominantly private sector suburbs that were developed in the period between the 1940s and the 1960s, and set within the context of Sydney's current Metropolitan planning framework - the City of Cities - the research has explored the process of urban renewal, assessed the urban design and social outcomes of urban consolidation in these suburban areas and has developed a series of policy recommendations to better manage these outcomes.

Final stages of the research were completed in early 2008, bringing together extensive insight from local strategic planners, real estate agents, planning consultants, and local developers and developer-builders. A model of the development process to assess economic feasibility of redevelopment in these areas was developed with the assistance of Dr Richard Cardew. In order to better understand the potential for change, 3D visualisations of existing and potential residential redevelopment outcomes based on a series of development scenarios were employed. In the latter part of 2008, a series of practitioner and public seminars were held to disseminate findings, including an event held with SGS Economics, the Department of Planning and Landcom in Parramatta in October attended by around 150 people. The team has also published a number of refereed publications based upon the research, and are currently preparing a final report to the ARC and laying preparations for a book on sustainable, suburban renewal.

For more information regarding this project, please visit the project website:  
<http://www.fbe.unsw.edu.au/cf/research/cityfuturesprojects/urbanrenewal/>

### **Assessing the Effectiveness of Public Housing Estate regeneration in NSW (ARC LP0668205)**

The project is a three-year research program to develop and implement a framework for the evaluation of the Urban Renewal programs currently being developed by Housing NSW for its housing estates. The project is jointly funded by the Department and the Australian Research Council (ARC). The project commenced in 2006 and is due for completion at the end of 2009. While the framework will be concerned with monitoring the outcomes of renewal within estates, a particular focus of the evaluation methodology will be in understanding the impacts of urban renewal programs on the neighbourhoods surrounding the renewal areas. An additional concern is to monitor the effect that public housing investment in an area might stimulate complementary private sector investment. This will entail addressing the issue of how the social cost/benefit outcomes of renewal programs can be effectively measured and addressed.

2008 was a busy year for the two APA(I) students attached to the project, with surveys involving over 350 residents in two localities with a high proportion of social housing in Metropolitan Sydney. These were complemented by a series of interviews with government, NGOs and service providers working with communities in each area.

For more information regarding this project, please visit the project website:  
<http://www.fbe.unsw.edu.au/cf/research/cityfuturesprojects/urbanimprovement/>

## **AHURI PROJECTS**

### **The Housing Affordability Impacts of Local Government Building Controls, State Government Charges and Other Regulations – AHURI Project 70393**

This project draws on this international research and an objective evaluation of existing Australian data to develop a consistent approach for understanding the cost effect of planning regulations and charges on house prices and affordability in Australia. The project has attempted to quantify the cumulative cost impacts of state and local government regulations and charges in a selection of case study developments in new release and urban renewal areas across inner city, suburban, and non-metropolitan local government areas in SE Queensland, Sydney and Melbourne. It aims to evaluate the cost impacts of existing and proposed regulation on housing production against the explicit objectives of the regulation, as a basis for avoiding unnecessary or unjustifiable regulation and for offsetting affordability

impacts where these are unavoidable. The project is being jointly conducted with the AHURI Research Centre at Sydney University (Dr Nicole Gurren). An AHURI Positioning Paper on this project, setting out the background literature and policy review, was published on the AHURI website in April 2008.

<http://www.fbe.unsw.edu.au/cf/research/ahuri/projects/planninggovernmentchang/>.

The final report is due in July 2009.

### **The Efficient Use of Dwellings and Land by Older Homeowners – AHURI Project 70392**

This project is jointly funded by AHURI and the Commonwealth Department of Health and Ageing (DoHA) and responds to the need identified by AHURI to understand the types, sizes and locations of dwellings occupied by older home owners, how these vary for different household sizes and what incentives or disincentives could encourage or discourage the efficient use of dwellings and land occupied by older home owners. Supplementary funding from DoHA was provided to expand its remit to investigate the cost-benefit of implementing 'adaptable', 'universal' and 'visitable' approaches to housing design, to ascertain the level of demand for these approaches and develop an economic model for determining the consequences if not adopted.

Methods used to investigate these issues included an analysis of data from the 1996, 2001 and 2006 Censuses and the 1999 Australian Housing Survey; a national survey of 1782 older home owners undertaken via the National Senior's Associations magazine '50 Something' and 70 in-depth interviews with selected survey respondents from four states (NSW, Victoria, Queensland and WA) and the ACT. The survey and interviews cover a range of issues including: type, number of rooms and floor area of the dwelling; household characteristics including need for assistance; frequency, importance of proximity and transport accessibility of activities outside the home; past and likely future modifications to the dwelling; attitudes to options for moving or improving efficient use of the dwelling by sharing; and attitudes to 'universal', 'adaptable' and 'visitable' design options.

The results of the study will be useful in informing policy on appropriate built environment responses to the ageing of Australia's population, including not only the design of the dwelling, but also associated private open space and the design and provision of neighbourhood and transport infrastructure facilities.

For more information regarding this project, please visit the project website:

<http://www.fbe.unsw.edu.au/cf/research/ahuri/projects/theefficientuseofdwellings/>

### **Innovative Financing For Homeownership: the potential for shared equity in Australia – AHURI Project 70394**

This project provides a comprehensive appraisal of the appropriateness and potential for shared equity models to assist households into affordable home ownership, and the role of Government intervention in this regard. City Futures are conducting this research in conjunction with colleagues at the University of Sydney (A/Prof. Yates and Milligan) and international expertise from Dr Peter Williams (UK). The positioning paper for the project was completed and published in 2008, and initial findings from the research presented at the National Housing Conference held in Sydney in February. In mid-2008, the second stage of fieldwork involved ten focus groups with potential customers in Sydney, Melbourne and Brisbane. Based upon these discussions, alongside consideration of wider policy, market, financial and lender considerations, the final report (to be completed early 2009) will present a series of policy recommendations.

For more information regarding this project, please visit the project website:

<http://www.fbe.unsw.edu.au/cf/research/ahuriprojects/innovativefinancing/>

### **Innovations in the Provision of Affordable Housing– AHURI Project 60504**

This project investigates recent innovations in the policy, funding, delivery and regulatory environment for the provision of affordable housing across Australian jurisdictions. The focus of the research is on the operating environment of not-for-profit organisations that are undertaking the financing and development of affordable housing. By comparing evidence across states and territories, the research aims to discern what has been effective policy and practice, and to make a case for strategies that would be capable of supporting larger scale growth in this emerging industry in Australia. The project also includes an assessment of comparable but better established not-for-profit housing models in selected European countries, which may offer good ideas and lessons for local policy making. The research team is led by Vivienne Milligan and includes researchers at the Universities of Queensland, Western Sydney and Sydney.

For more information regarding this project, please visit the project website:

<http://www.fbe.unsw.edu.au/cf/research/ahuriprojects/innovationsintheprovision/>

### **Low-Income Home Ownership Support Programs: A Review of Past Schemes and Consideration of Future Potential– AHURI Project 70541**

This research aims to provide a comprehensive overview of Government low-income home ownership support programs in Australia. It considers the design, remit and objectives of recent programs across a number of states and territories and draws upon lessons learned from previous schemes from the 1980s which were met with varying degrees of success. Outcomes of the research will contribute to our understanding of the viability and effectiveness of the range of mechanisms supporting lower-income groups' entry into, and ability to sustain homeownership.

The project aims to:

- Provide an overview and assessment of Government low-income homeownership support programs. This will draw upon lessons from earlier state schemes and compare current programs with products offered by private sector providers.
- Consider the appropriate roles and the costs and benefits of low-income homeownership support programs given changing economic circumstances and housing market dynamics.
- Help determine the most effective support in terms of targeting, cost, and value for money for Government, provider and consumer alike that can be provided in assisting access to, and maintain, low-income home ownership.

The project was awarded in May 2008 and will be completed in late 2009. In late 2008, the researchers travelled to Adelaide, Perth and Darwin to speak with stakeholders involved in the HomeStart, HomeWest and HomeNorth organisations, as well as Indigenous Business Australia, organisations that are all involved with the provision of low-income home ownership support schemes. Surveys with clients of these organisations will be conducted in mid-2009.

For more information regarding this project, please visit the project website:

<http://www.fbe.unsw.edu.au/cf/research/ahuriprojects/lowincomehome/>



## OTHER CITY FUTURES PROJECTS

### **Baseline Monitoring and Evaluation of Building Stronger Communities**

Funded by: Housing NSW

City Futures Research Centre was engaged by Housing NSW Department in early 2007 to develop a monitoring and evaluation framework for the Building Stronger Communities initiative. The framework employs a mix of qualitative and quantitative research methodologies in order to offer the department, local partnerships and the community themselves a framework for engagement and assessment of both process and outcomes. Following completion of the framework, the Centre successfully tendered to undertake the baseline fieldwork and reporting for the Building Stronger Communities team. This commenced in January 2008 with the collection of over 1600 resident surveys and 75 key stakeholders involved with the planning and implementation of the strategy in each of the priority locations. A series of reports were delivered in mid-2008, including a program-wide comparative report and individual reports focusing in on each of the Priority Location areas. The research was reported to practitioners and policymakers in the latter half of the year.

For more information regarding this project, please visit the project website:

<http://www.fbe.unsw.edu.au/cf/research/cityfuturesprojects/bsc/>

### **Negotiating Development Approval in NSW: recognising formal and informal development relations**

Funded by: Internal UNSW Grant

This research will explore the propensity of local councils to mobilise informal associations and negotiation for the purpose of facilitating development approval in NSW. The research will trace these relations through mobilising a questionnaire which will be sent to senior council staff in all NSW LGAs. The questionnaire will explore the experiences of council in using the frameworks which support informal relations and negotiation, council opinions of the validity of such frameworks and review the types of developers who mobilise such frameworks for the purpose of securing development approval. The second component of the research will involve a series of in-depth interviews with senior council staff. These interviews will facilitate a more detail and nuanced understanding of the relationship between developers and councils.

The objectives of the project are to explore the ways in which plans and development applications are negotiated through local council. The aims of the project are:

- To identify the extent to which informal associations/negotiations are promoted in council/state policy in NSW
- To identify the extent to which councils in NSW experience negotiation over development approval, the extent to which they endorse/support the negotiation process and identify the type of development most likely to mobilise informal associations in their area
- To review Australian and international literature on informal associations and development negotiations
- Submit a ARC Discovery application

To date little research has been conducted in Australia which explores the interaction of formal and informal relations in urban development and planning.

For more information regarding this project, please visit the project website:

<http://www.fbe.unsw.edu.au/cf/research/cityfuturesprojects/negotiatingdas/>

### **MOSAIC Baseline Survey**

Funded by: Housing NSW

This project is an extension of 'Assessing the Effectiveness of Public Housing Estate regeneration in NSW' (ARC LP0668205) funded by the Australian Research Council and Housing NSW. Towards the end of 2008, City Futures was engaged to undertake a community survey in Telopea/Dundas and Ermington social housing areas. In total 1200 face-to-face surveys were held with local residents, both on estates and in surrounding areas. The results will feed into the wider MOSAIC project. The project will report in early 2009.

For more information regarding this project, please visit the project website: <http://www.fbe.unsw.edu.au/cf/research/cityfuturesprojects/telopea/>

### **Innovation and Technology Challenges for the Built Environment Industry**

Funded by: Commonwealth Department of Innovation Industry Science and Research

The built environment, especially that of our largest cities, faces substantial change in the next twenty years if it is to meet the increasing demands for carbon neutrality, reduced water consumption and more efficient resource consumption. The industries that design, build, retrofit, manage and maintain the built environment face equally significant changes in organisation, working practices and skills development, approaches to design and construction and materials development if they are to meet these challenges. Equally, the institutional and governance structures within which they operate will need to undergo fundamental changes, not least in terms of changed regulatory and incentive structures to stimulate innovation and adaptation of new sustainability goals and outcomes. This report, specially commissioned by the Commonwealth Department of Innovation Industry Science and Research reviewed the key drivers of change facing the built environment and analysed the major challenges facing the built environment industry, broadly constituted, in adapting to these drivers. The research was based on a series of high level interviews with senior industry stakeholders and an extensive web-based review of recent policy documentation and other literature. The report was presented to the first meeting of the newly constituted Built Environment Innovation Council in Melbourne in September 2008.

This report can be downloaded from the City Futures website at <http://www.fbe.unsw.edu.au/cf/research/cityfuturesprojects/DIISR/>. A shorter version of the report was published as Pinnegar, S, Marceau, J and Randolph, B. (2008) 'Innovation for a Carbon Constrained City: Challenges for the Built Environment Industry'. *Innovation: Management Policy & Practice*, 10, 303-315.

### **Managing Major Repairs in the Residential Strata Sector**

Funded by: NSW Office of Fair Trading

The aim of this study is to undertake research into the attitudes towards, and practice of, funding major repairs in the residential strata sector in NSW. The findings will provide strata owners, owners' corporations, strata managers and policy makers with new and systematic information on issues surrounding the provision for major repairs in strata in NSW. The project has three aims:

1. To establish current practices in respect to funding major repairs and maintenance in residential strata titled complexes.
2. To explore the attitudes and knowledge of planning for major repairs funding among consumers of residential strata, including resident- and investor-owners and owners' corporation members.
3. To undertake a benchmarking exercise based on data collected by strata property managers in order to estimate the types of information available on



maintenance and major repairs at the block level, to identify the form in which this information is recorded and to assess how easily the data can be accessed and how easily it can be analysed for trends.

The research began in August 2008 and is expected to be completed in July 2009. To date, a literature review and a review of the NSW strata legislation relating to funding for major repairs and maintenance has been undertaken. An online survey of owners of residential strata properties was launched in September 2008, and closed in April 2009. Over 240 owners completed this survey and analysis of the survey results is underway. A number of strata management companies were also contacted in late 2008 and asked to participate in the study by providing information on the types of information available on major repairs and maintenance at the block level and the form in which this data is recorded and how easily it can be accessed electronically. Strata management agents were been asked to provide the research team with examples of management data where possible. The confidentiality of this data was assured. The response from strata management agents was poor, however we have received support as well as some data from three strata management companies (one small, one medium and one large company).

It is expected that this research will directly inform best practice, policy innovation and educational programmes for practitioners and policy makers in the sector. The findings of the research will be presented in a final report to the Office of Fair Trading. A short key findings summary will also be written for wider dissemination. In addition, Dr Easthope will hold a public seminar on the results of the research in June 2009, hosted by the Institute of Strata Title Management (NSW).

For more information regarding this project, please visit the project website: <http://www.fbe.unsw.edu.au/cf/research/cityfuturesprojects/managingmajorrepairs/>

**Fringe, Renewal Trends: Briefing February 2008** Funded by: Landcom This project, commissioned by Landcom, aimed to understand the demand side factors that we leading to a significant market down turn for new properties on the urban fringe of Sydney. In addition, a comparable analysis was also included that looked at the demand for homes in the middle suburbs of the city in what have been targeted as areas for urban renewal. The study focused on the increased polarisation in household incomes and the disjuncture of recent economic growth (explicitly inner Sydney based) and the locations where family housing has traditionally been in most demand. Expansion on the urban fringe further distances these new markets from those households / purchasers who might be able to afford the properties in the first place and from more vibrant urban labour markets.

The study addressed three core questions:

- 1 How much, if at all, has proposed new fringe development distanced itself from the traditional markets in terms of price? New and existing sales and migration propensities were analysed to examine whether the distance – from traditional ‘feeder’ areas – has led to a failure of established drivers of housing demand for fringe housing;
- 2 The localised labour market for the new release locations was also tested to assess the relationship of these location’s workforces to the areas of prime economic growth – i.e. does (long distance) commuting play such a fundamental role in the relationship of these areas – or are their employment basis more localised (and of lower occupational, and thus financial, capacity), and thus maybe not as exposed to the economic growth of Sydney as a whole?
- 3 A third component analysed the price and demand trajectories for middle suburban locations which have traditionally provided more affordable housing for families as well as acting as source locations for households trading up to the urban fringe.



The study combined detailed migration profiling using time series Census data and analysis of the Valuer General's Property Price database.

The Final Report from this project is not available.

### **30 Year Plan for Greater Adelaide**

Funded by: KPMG City Futures was commissioned as part of the KPMG led team to work on aspects of the Draft 30 Year Plan for Greater Adelaide. This project focused on developing a draft Affordable Housing Strategy for the Plan as part of KPMG's Land Use team for the project. The report submitted by City Futures considered aspects of affordable housing demand and supply and provided draft policy options for meeting the projected demand for such housing across the Greater Adelaide are linked to broader Plan objectives.

The Final Report from this project is not available.

# 6

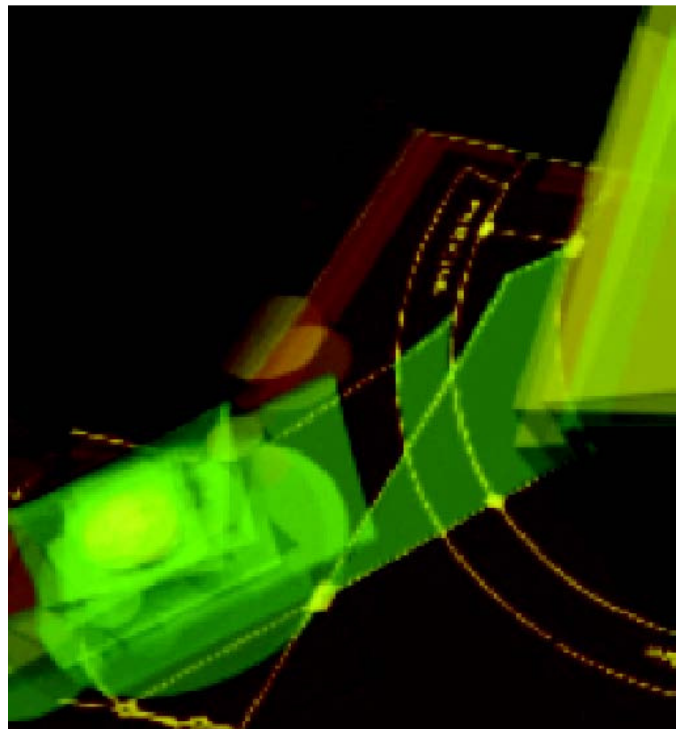

DISSEMINATION: PUBLICATIONS,  
PRESENTATIONS, SEMINARS

# 6 DISSEMINATION: PUBLICATIONS, PRESENTATIONS, SEMINARS

## PUBLICATIONS

### Book Chapters

Judd, B. & Randolph, B.	'Quality or Quantity? The Role of Qualitative Research' in <i>Evaluating Urban Renewal Programs</i> in Paul Maginn, Susan Thompson & Matthew Tonts (eds.) <i>Qualitative Urban Analysis: An International Perspective</i>
Kubler, D. & Randolph, B.	'Metropolitan Governance in Australia', in Hambleton, R. & Gross, J. (eds) <i>Global Cities in a Global Era: Urban Innovation, Competition and Democratic Reform</i> , New York USA: Palgrave Macmillan, pp 139-150
Marceau, J.	J. Marceau, 'Innovation' in <i>International Encyclopaedia of Organization Studies</i> , Volume 2 pp 670 673,
Marceau, J., Turpin, T. & Woolley, R.	'The Heroes of Innovation? Scientists and Technologists in Australian Business', in N. Kennedy (ed.) <i>Inside the Innovation Matrix: finding the hidden human dimensions</i> , Australian Business Foundation, Sydney, pp. 96-111

### Refereed Journal Articles

Bunker, R.	'Why and how did Adelaide come about?' <i>Planning Perspectives</i> , (2008) Vol. 23 Issue 2, pp. 233-240.
Bunker, R. & Searle, G.	'Seeking Certainty: Recent Planning for Melbourne and Sydney'. <i>Town Planning Review</i> (2008)
Cook, N. & Ruming, K.	'On the Fringe of Neoliberalism: Service and Infrastructure Provision in Residential Development in Sydney', <i>Australian Geographer</i> , 39, 1 (2008).
Easthope, H. & Gabriel, M.	'Turbulent Lives: Exploring the Cultural Meaning of Regional Youth Migration', <i>Geographical Research</i> , Vol. 46, No. 2, pp. 172-182.
Marceau, J.	'Introduction: Innovation in the city and innovative cities', <i>Innovation: management, policy &amp; practice</i> (2008) Vol. 10, pp 136-146
Pinnegar, S., Marceau, J. & Randolph, B.	'Innovation for a carbon constrained city: Challenges for the built environment industry', <i>Innovation: management, policy &amp; practice</i> (2008) Vol. 10, pp.303-315
Randolph, B. & Troy, P.	'Attitudes to conservation and water consumption', <i>Environmental Science &amp; policy</i> 2, (2008) pp. 441-455
Turpin, T., Woolley, R., Marceau, J. , & Hill, S.	'Conduits of knowledge in the Asia Pacific' (2008) <i>Asian Population Studies</i> , Vol 4, No. 3, pp. 247 — 265

---

**Refereed AHURI Reports**

---

- |   |  |
|---|--|
| Gurran, N., Ruming, K., Randolph, B. & Quintal, D.                              | 'Planning, government charges , and the costs of land and housing', (2008) AHURI Positioning Paper No 109                                  |
| Pinnegar, S., Milligan, V., Quintal, D., Randolph, B., Williams, P. & Yates. J. | 'Innovative financing for home ownership: the potential for shared equity initiatives in Australia', (2008) AHURI Positioning Paper No 106 |
- 

---

**Refereed Conference Publications**

---

- |  |   |
|--|---|
| Barton, J.   | 'UrbanIT: Harnessing Urban Ontologies to Better Support Urban Sustainability'. Extended Abstract, 3dGeoInfo08. Seoul, Korea November 2008   |
| Marceau, J.  | 'Innovation agents: The inter-country mobility of scientists and the growth of knowledge hubs in Asia', DRUID 25th Celebration Conference 2008, Copenhagen, June 2008                                   |
| Turpin, T., Doloswala, N., Woolley, R. & Marceau, J. | 'Learning, leaving and linking: tapping he training careers and networks of knowledge workers for developing countries', Proceedings from the GLOBELICS 6th international conference, Mexico City, 2008 |
| Xu, T.   | 'Heterogeneity in housing attribute prices', 14th Annual PRRES Conference, Malaysia January 2008  |
- 

---

**Non-Refereed Journal Articles**

---

- |                             |  |
|-----------------------------|--|
| Atkinson, R. & Easthope, H. | 'The Creative Class in Utero? The Australian City, the Creative Economy and the Role of Higher Education', Built Environment (2008) Vol 34 o 307-318 |
| Bunker, R.                  | 'A Plenitude, Plethora or Plague of Plans?' Built Environment (2008) Vol. 34, pp. 319-332  |
| Troy, P. & Randolph, B.     | 'A new approach to Sydney's domestic water supply problem', Built Environment (2008) Vol. 34, pp. 333-348  |
- 

---

**City Futures Research Papers**

---

- |                                       |   |
|---------------------------------------|---|
| Bunker, R.                            | 'Metropolitan Strategies in Australia' City Futures Research Centre Research Paper No. Research Paper No. 9, July 2008                      |
| Randolph, B. & Freestone, R.          | 'Problems and Prospects for Suburban Renewal: An Australian Perspective' City Futures Research Centre Research Paper No. 11, September 2008 |
| Randolph, B., Pinnegar, S. & Tice, A. | 'Our Changing City Sydney: A Census Overview 2001-2006' City Futures Research Centre Research Paper No. 8, January 2008                     |
-

---

**Issues Papers**

---

Freestone, R., Foster, K. & Williams, P.	'Towards a National Aviation Policy Statement', City Futures Research Centre Issues Paper No. 5, June 2008
Pinnegar, S., Marceau, J. & Randolph, B.	'Innovation and the City: Challenges for the Built Environment Industry', City Futures Research Centre Issues Paper No. 7, July 2008
Randolph, B.	Socially Inclusive Urban Renewal in Low Value Suburbs: A Synopsis of Issues and an Agenda for Action' B. Randolph, City Futures Research Centre Issues Paper No. 6, July 2008

---

**Research Reports  
(unpublished)**

---

Randolph, B, Pinnegar, S, and Tice, A.	Fringe, Renewal Trends. Briefing Paper 2008.
Ruming, K, Pinnegar, S. and Randolph, B.	Building Stronger Communities: Monitoring and Evaluation Baseline Report, Housing NSW September 2008
Ruming, K, Pinnegar, S. and Randolph, B.	Macquarie Fields Monitoring and Evaluation Baseline Report, Housing NSW September 2008
Ruming, K, Pinnegar, S. and Randolph, B.	Claymore Monitoring and Evaluation Baseline Report, Housing NSW September 2008
Ruming, K, Pinnegar, S. and Randolph, B.	Orange Bathurst Monitoring and Evaluation Baseline Report, Housing NSW September 2008
Ruming, K, Pinnegar, S. and Randolph, B.	Mount Druitt Monitoring and Evaluation Baseline Report, Housing NSW September 2008
Ruming, K, Pinnegar, S. and Randolph, B.	Killarney, Bateau Bay, Tumbi Umbi Monitoring and Evaluation Baseline Report,
Ruming, K, Pinnegar, S. and Randolph, B.	Dubbo Monitoring and Evaluation Baseline Report
Ruming, K, Pinnegar, S. and Randolph, B.	Minto Monitoring and Evaluation Baseline Report

---

## PRESENTATIONS

---

### Australasian Conference Presentations

---

Barton, J.,	FBE Research RoundUp: UrbanIT: 3D City Modelling for Planning Support, December 2008
Barton, J.,	Creative Media presentation and poster, <i>An Integrated Framework to Support Urban Planning and Analysis</i> , Three dimensional city modelling, 3 December 2008
Barton, J.,	Sydney Mechanics School of Arts: Urban Modelling, 13 August 2008
Easthope, H., Randolph, B. & Tice, A.	"The Desirable Apartment Life? Residential preferences of apartment residents in Sydney and Melbourne", Institute of Australian Geographers Conference, Hobart, 30th June-2nd July 2008
Randolph, B.	<i>Low income working private renters: The group that housing policy forgot?</i> Shelter NSW Annual Conference, 26 June, Sydney (Invited speaker).
Easthope, H. & Randolph, B.	"When Private Becomes Public: Issues arising from the provision of publicly-accessible infrastructure in master-planned estates" Australasian Housing Researchers Conference, Melbourne, 18th-20th June 2008
Ruming, K.	"A New Network Direction in Housing Studies: the case of Actor-Network Theory" Australasian Housing Researchers Conference, Melbourne, 18th-20th June 2008
Tice, A.	"Affordability or Availability? Developing Housing Market Monitors", Australasian Housing Researchers Conference, Melbourne, 18th-20th June 2008
Randolph, B.	<i>Socially Sustainable Urban Renewal in Western Sydney</i> , WSROC Sydney: The Other City Regional Conference, 29-30 <sup>th</sup> April, Penrith (Invited Speaker).
Coates, B., Judd, B., Kavanagh, D. and Unsworth, L.	Community Engagement in Bonnyrigg. <i>National Housing Conference</i> , Sydney, 20 <sup>th</sup> -22 <sup>nd</sup> February, 2008.
Pinnegar, S.	'Innovative Financing for Home Ownership: The potential for shared equity initiatives in Australia', National Housing Conference, Sydney, 22 February 2008

---

---

**International Conference Presentations**

---

Barton, J.	UrbanIT: Harnessing Urban Ontologies to Better Support Urban Sustainability. Extended abstract, 3dGeoInfo08. Seoul, Korea November 2008
Barton, J. & Plume, J.	Working Toward Urban Sustainability for Inner-City Development. Proceedings from the 10th Annual Sharjah Urban Planning Symposium, American University of Sharjah, November 23-25, 2008
Judd, B. and Quinn, J.	Size ≠ Utilize: Housing Occupancy, Utilisation and Participation of Older Australians. <i>'Design for an Ageing Society', International Federation of Ageing's 9<sup>th</sup> Global Conference</i> , Montreal, Canada, 4-7 <sup>th</sup> September, 2008. (published on IFA website: <a href="http://www.ifa-fiv.org/">http://www.ifa-fiv.org/</a> )
Quinn, J and Judd, B.	Modified, Adaptable or Universal? Housing Design Approaches and Participation in an Ageing Society. <i>'Design for an Ageing Society', International Federation of Ageing's 9<sup>th</sup> Global Conference</i> , Montreal, Canada, 4-7 <sup>th</sup> September, 2008.
Judd, B. & Coates, B.	Building Community Capacity in Housing and Urban Design in a Regenerating Suburb: The Bonnyrigg Experience. 2008 <i>European Network for Housing Research Conference</i> , Dublin, Ireland, 6-9 <sup>th</sup> July, 2008.
Randolph, B.	<i>Understanding the processes of disadvantage and the possibilities renewal in suburban Australia – the Sydney case</i> . Paper presented to the ENHR Conference, Dublin, 6 – 9 <sup>th</sup> July 2008.
Randolph, B. & Freestone, F.	<i>Problems and Prospects for Suburban Renewal: An Australian Perspective</i> . Paper presented at the A Suburban World? Global Decentralisation and the New Metropolis Conference, Virginia Tech, Reston, Virginia 8 April 2008.

---

**Community/Practice Presentations**

---

Pinnegar, S. & Randolph, B.	<i>Socially sustainable urban renewal – Fairfield</i> Presentation to Fairfield City Council, December 2008
Pinnegar, S. & Randolph, B.	<i>Socially sustainable urban renewal – HNSW</i> Presentation to HNSW Living Communities Group, December 2008
Barton, J.	UrbanIT Advisory Committee meetings on 28 Mar 2008, 26 June 2008, and 5 Dec 2008.
Pinnegar, S. & Randolph, B.	<i>Socially sustainable urban renewal – Penrith</i> Presentation to Penrith City Council, November 2008
Milligan, V.	<i>Affordable Housing Innovation in Australia</i> , Presentation to Developing Affordable Housing Course for NSW Housing Associations, University of Western Sydney Parramatta, November 26-28 2008
Milligan, V.	<i>Public Housing – Going Going Gone?</i> Presentation to Wayside Chapel, "Public Housing for the Future", Sydney, November 20 2008
Randolph, B. &	<i>Innovation And Technology Challenges For The Built</i>



Pinnegar, S.	<i>Environment.</i> Presentation to the Built Environment Innovation Council, 30 October, Melbourne. (Invited speakers)
Randolph, B.	<i>Canterbury: Children, Poverty, Flats and Affordability,</i> Families Living in Stress Forum, the Canterbury Child and Family Interagency, 29 October, Lakemba, Sydney (Invited speaker).
Milligan, V. & Gurrán, N.	<i>New Solutions in Affordable Housing,</i> Thursday Night Lecture, Faculty of Architecture, Design & Planning University of Sydney, October 23 2008
Randolph, B.	<i>Renewal in a Polarised City: Will the market deliver the numbers?</i> Landcom Staff Sustainability Seminar 16 October, Parramatta (invited speaker)
Randolph, B.	<i>Social Exclusion and Location: Why Place Matters.</i> ACOSS Seminar, 2 October, Sydney (Invited speaker).
Randolph, B.	Socially Sustainable Urban Renewal: Delivering more than numbers. Presentation to the <i>Making Urban Renewal Work</i> Seminar, 1 October, Parramatta. City Futures Seminar.
Randolph, B.	<i>Social exclusion, location, &amp; infrastructure.</i> ACOSS 2008 Civil Society Dialogue Forum, 16 September, Old Parliament House, Canberra (Invited speaker).
Randolph, B.	<i>Supporting mixed tenure communities</i> NSW Community Housing Annual Conference, 10 September, Sydney (Invited speaker).
Milligan, V.	<i>Developments in Affordable Housing: Completing the Jigsaw,</i> 2008 NSW Community Housing Conference “Change, Challenge, Innovation Inclusion”, 10-11 September 2008, Sydney
Randolph, B.	<i>Contemporary Australian evidence on urban disadvantage and renewal</i> AHURI Urban Renewal Seminar, 4 Sept, Parliament House, Canberra (Invited speaker).
Randolph, B.	<i>Housing Unaffordability in Australia,</i> ALP ‘Friends of Sustainable Cities’, 26 August, Parliament House, Canberra (Invited speaker).
Randolph, B.	Department of Planning Annual Young Planner Professionals Forum 2008, Department of Planning, 15 August, Sydney (Invited speaker).
Easthope, H.	“High Density Melbourne”, Andreones Managers Forum, Melbourne, 22 <sup>nd</sup> July 2008
Easthope, H.	“High Density Sydney”, Andreones Managers Forum, Sydney, 11 <sup>th</sup> July 2008
Randolph, B. and Pinnegar, S.	<i>Unpacking housing unaffordability – experiences from the margins of the housing market,</i> SPRC Seminar, UNSW, 10 June, Sydney (Invited speaker).
Pinnegar, S.	<i>Housing affordability,</i> Guest Speaker UDIA Young Developers Forum, 9 July 2008
Randolph, B.	<i>Development prospects in Western Sydney.</i> Presentation to the NSW Land Supply CEO’s meeting, Department of Planning, 4 June, Sydney (Invited speaker).
Randolph, B.	<i>Households under stress: The where, why and where to of housing unaffordability?</i> Social Policy in the City Seminar: Housing Affordability, Stability and Policy Solutions, 28 May,

Sydney (Invited speaker)	
Randolph, B.	<i>The expansion of urban consolidation: Social Impacts and considerations</i> , 3 <sup>rd</sup> Annual Metropolitan Planning and Design Summit, 27 May, Sydney (Invited speaker).
Randolph, B.	<i>Social Mix and Estate Renewal</i> , Tasmanian Department of Housing Roundtable, 6 May, Hobart (Invited Speaker).
Randolph, B.	<i>Location social exclusion: the case of Sydney</i> , Paper presented at the <i>Social Inclusion and Place Based Disadvantage Workshop</i> , Brotherhood of St Lawrence, 13 June, Melbourne (Invited speaker).
Randolph, B.	<i>Social inclusion and urban renewal</i> , How Sustainable is Urban Consolidation Seminar, 2 May, UTS, Sydney (Invited speaker).
Randolph, B.	Invited Presentation to the Senate Enquiry into Housing Affordability, 2 April, Commonwealth Office, Sydney.
Randolph, B.	<i>Development prospects on the Urban Fringe and Urban Renewal</i> , 19 February, Presentation to the Landcom Board, Sydney (Invited speaker).
Randolph, B.	<i>Key Housing Issues in a Planning Context</i> , Living Cooperatively Symposium, 13 <sup>th</sup> -14 <sup>th</sup> February, Sydney (Invited Speaker).

## SEMINARS AND CONFERENCES

### 1. Ageing & Housing – Prospects for Ageing in Place

Wednesday 12th November, 2008, UNSW

Speaker – Dr Diana Olsberg

Current economic uncertainties and new figures of projected increases in the ageing population in the Newcastle region bring the future life prospects for older men and women to the top of the agenda for older people, their families and for all policy makers and service providers in the Newcastle region.

One of Australia's foremost academic researchers Dr Diana Olsberg PhD FAICD from the University of New South Wales addressed these concerns in the context of her path-breaking studies of older Australians. She addressed these issues as they interact with her findings on the shift in the values and attitudes of many older Australians which is transforming their expectations for retirement lifestyles and their future housing intentions and expectations.

Independence, flexibility, consumer and lifestyle choices are now key values for older Australians. The main contributing factors are increased longevity, changing family relationships, new forms of identity formation and social expectations, greater social mobility and greater diversity in the older population concerning their life passages.

### 2. Current Issues in the Management of Indian Cities

20<sup>th</sup> October 2008, Red Centre (West Wing), UNSW

Speaker: Dr Chetan Vaidya, Director National Institute of Urban Affairs, India

Chetan Vaidya, Director of the National Urban Institute of Affairs (NIUA), has over 30 years of urban development planning and management experience working for the Government of India, the Planning Commission, State Governments, Urban Local Bodies and financial institutions.

### 3. Making Urban Renewal Work (co-hosted by SGS Economics)

1<sup>st</sup> October 2008, Mantra Hotel Parramatta

Speakers included: Alex Gooding, CEO WSROC, Patrick Fensham (Director SGS Economics and Planning) and Prof Bill Randolph

The State Government's 2005 Metropolitan Strategy aims to deliver 640,000 dwellings to 2031 – around 23,500 per year from 2004. Sixty to seventy percent of the new dwellings are to be in established areas in and around Sydney's centres intending to increase densities and activity in areas with good public transport access, while constraining growth into valuable urban fringe lands. However, since the release of the Strategy, progress has been limited. In the established areas, simply re-zoning land for higher density residential is unlikely to be sufficient. There are few 'easy' development sites available in the required locations. Development in most middle and outer parts of Sydney is typically unviable in current market conditions and existing physical and community infrastructure may be unable to cope with higher residential densities. And community opposition to ad hoc and poor quality development is a further barrier to renewal.

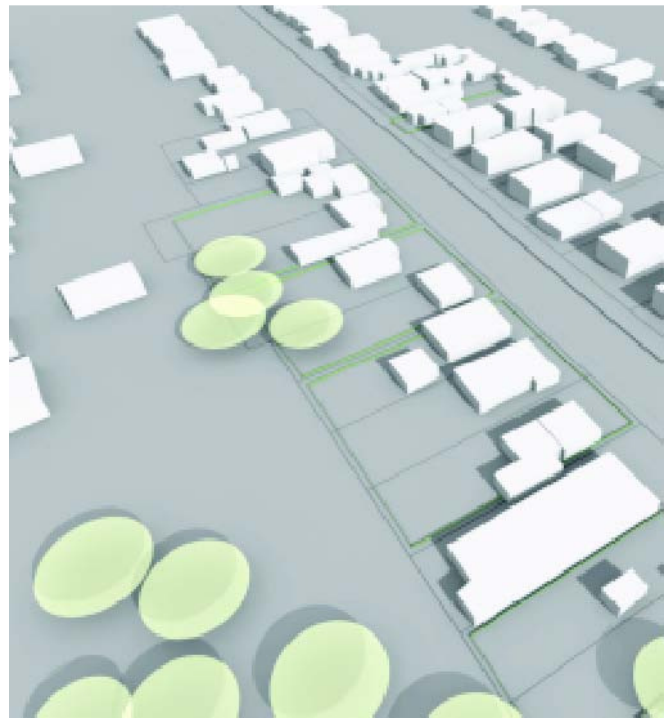

# 7

## TEACHING AND SUPERVISION

# 7 TEACHING AND SUPERVISION

## SUPERVISION OF PhD STUDENTS

<b>Name of Student</b>	<b>Topic</b>	<b>Supervisor</b>
Aida Morden submitted 2008	Social Dynamics of the Landlord-Tenant Relationship: Litigations in Public Housing	Prof Bill Randolph and Dr Bruce Judd*
Bernadette Pinnell (APAI)	Establishing an evaluation framework to measure the Impact of public housing estate renewal in NSW on the areas surrounding the estate; using GIS as a tool for communicating the impact of the regeneration	Prof Bill Randolph and Dr Simon Pinnegar*
Cathy Sherry	Significance of Strata and Community Title	Prof Brendan Edgeworth and Prof Bill Randolph*
Gary Shields	Planning for Ageing	Dr Susan Thompson and Prof Bill Randolph*
Jack Barton (PhD awarded in 2008)	A Spatial Decision Support System for Public Housing	Dr Bruno Parolin, Dr Bruce Judd* and Jim Plume*
Jing Xie	Mixed-Use Communities: Ancient Rome	Prof Xing Ruan and Dr Simon Pinnegar*
Joanne Quinn	Design of the Home Environment for the Ageing Population	Dr Oya Demirbilek and Dr Bruce Judd*
Lydia Kirkoff	Urban Socio-cultural Development in the context of the Creative Industries in Auckland	Prof Bill Randolph and Prof Rob Freestone
Lucy Groenhart (APAI)	Social Cost Benefit Analysis of Public Housing Estate Regeneration in NSW	Prof Bill Randolph and Dr Simon Pinnegar*
Shane Geha	Development of an Empirical Model for the Quantification of the Rezoning Effect	Peter Williams and Prof Bill Randolph*
Shanlin Huang	Urbanisation in China: Rural-to-Urban Migration and Land Utilisation in Urban and Rural Areas	Prof Bill Randolph
Ting Xu	Housing differentials in sub-districts of Shenzhen, China: a geo-spatial analysis from profiles of house price, house types and households	Prof Peter Murphy and Prof Bill Randolph*

Wenji Cai	Housing Affordability in Wuhan: A Comparative Study	Prof Bill Randolph and Dr Vivienne Milligan *
-----------	--	--

\*Co-Supervisor

## SUPERVISION OF MASTERS STUDENTS

Darren Holloway	“Urban Consolidation and Public Transport Use: A Case Study of Sydney”	Prof Robert Freestone and Prof Bill Randolph*
Kate Wedgwood	Sydney Caravan Parks: Community and Closure	Dr Nancy Marshall and Dr Simon Pinnegar*
Sarah Hudson	Dire Stratas	Prof Bill Randolph and Peter Williams*

\* Co-Supervisor

## TEACHING

### A/Prof Vivienne Milligan

Session 2:

Affordable Housing Concepts, Developments, Organisations Presentation to  
UNSW FBE Design Students, August 2008

### A/Prof Bruce Judd

Session 1:

ARCH 7111/2 Design Studio 1 & 2

Session 2:

ARCH 7111/2 Design Studio 1 & 2

### Dr Simon Pinnegar

Session 1:

MPLAN 7122 Planning project, Project design, methods and supervision of student  
research projects (Course coordinator)

BPLAN4031 Research Design (Guest lecture)

BENV2091 City Planning Today (Guest lecture)

Session 2:

MPLAN 7122 Planning project, Project design, methods and supervision of student  
research projects (Course coordinator)

S2 MPLAN 7723 4121 Spatial Policy (Course lecturer)

BPLAN4132 5th year thesis supervision and marking (Part time tutor)



**Dr Hazel Easthope**

Session 2:

MPLAN 7122 Planning project, Project design, methods and supervision of student research projects (Course lecturer)

**Dr Jack Barton**

Session 1:

PLAN2801 GIS for Urban Environments

Filled in weeks 1-8 for Dr Bruno Parolin

Session 2:

BENV2411 / 7155 Urban Modelling

in collaboration with LAND1302, ARCH7111/7112 (included exhibition in FBE gallery space and exhibition in Town Hall House to come in 2009)

Summer Session:

BENV2311 Digital Drawing Body Sculpture

**Dr Kristian Ruming**

Session 2:

MPLAN 7122 Planning project, Project design, methods and supervision of student research projects (Course lecturer)

BPLAN4132 5th year thesis supervision and marking (Part time tutor)

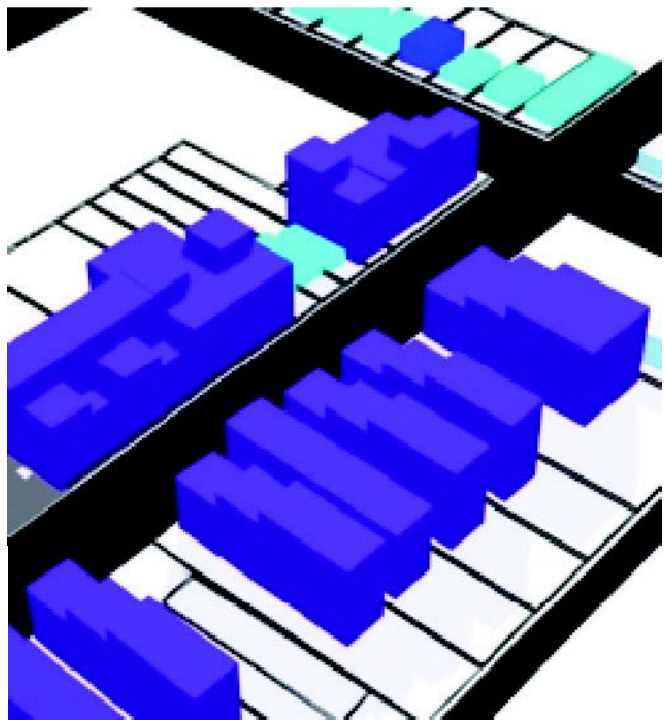

# 8

## STATEMENT OF FINANCIAL PERFORMANCE



# 8

## STATEMENT OF FINANCIAL PERFORMANCE

### OVERVIEW

The financial results for 2008 reflect a strong growth trajectory, building on the position achieved by the Centre during its previous years of operation. A surplus of \$247,921 was brought forward at the beginning of the year.

Over the year, new external research funding totalling \$1,197,009 was received. Support from the Office of the DVC (Research) originally consisted of \$311,703. \$131,703 of this funding was however tied to employment of Vivienne Milligan and Nicole Gurrán. Unfortunately Nicole Gurrán turned down her offer of employment and Vivienne Milligan did not commence with the Centre until August, so \$114,311 was returned at the end of 2008.

Expenditures for the year totalled \$1,279,096 of which \$727,474 were spent on salary cost for Centre Staff. This is not including Prof Bill Randolph's salary, which is underpinned by the Faculty. Materials (\$457,880) included the annual AHURI membership fee of \$ 113,448.53 exclusive of GST, 50% of which was reimbursed from UWS.

The net operating result showed a surplus of \$115,305 for the year, which, when added to the surplus brought forward from 2007, led to a final carry forward of \$363,227 to 2009.

### STATEMENT OF IN-KIND CONTRIBUTIONS

Since November 2005 City Futures has been located in newly refurbished accommodation on Level One of the Red Centre (west wing). The Centre does also receive in-kind contributions from the Faculty in the form of support from IT and Finance staff.

The Centre is in return charged a 15% levy from both the Faculty and Central UNSW on income generated from research projects with value exceeding \$20,000. These levies do not apply to projects awarded by ARC or AHURI.

## FINANCIAL STATEMENT 2008

		YTD Budget	Variance
	\$	\$	\$
<b>Income</b>			
External Funds *	1,197,009.60	1,363,000.00	-165,990.40
UNSW Contribution	197,392.07 ii)	197,392.07	0.00
<b>Total Income</b>	<b>1,394,401.67</b>	<b>1,674,703.00</b>	<b>-165,990.40</b>
<b>Expenses</b>			
Payroll	727,474.46	733,000.00	-5,525.54
Equipment	20,711.07	20,000.00	711.07
Materials	457,880.08	500,000.00	-42,119.92
Travel	73,030.78	60,000.00	13,030.78
<b>Total Expenses</b>	<b>1,279,096.39</b>	<b>1,313,000.00</b>	<b>-33,903.61</b>
<b>Operating result for the period</b>	<b>115,305.28</b>	<b>361,703.00</b>	
<b>Surplus(Deficit) Bfwd from Prior Period</b>	<b>247,921.81</b>	<b>247,921.81</b>	
<b>Retained Funds Surplus(Deficit)</b>	<b>363,227.09</b>	<b>609,624.81</b>	
* Excludes debtors (unpaid invoices)	<b>231,785.70</b>		

### Notes

- i) Unable to invoice for instalments for a few of our research projects as milestones had not yet been delivered.
- ii) Originally \$311,703 was granted to CF, but only \$197,392.07 was spent (due to Nicole Gurran turning down offer of employment).